

## 3-Way Angle Milling Vise

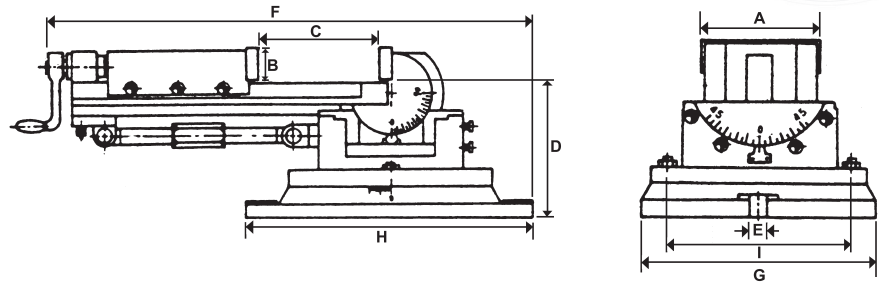

- Angles can be set in 3 dimensions. Swivels 360° around base. The vise can be elevated through 90° from the horizontal to vertical. And also can be tilted on its lower angle base up to 45° in both right and left.
- Tilting of any angle all keep the workpiece steady, smooth.
- Particularly the clamping part of screw is strengthened by a bush made of gunmetal.

### Specifications

Unit:mm

ORDER NO.	A	B	C OPEN	D	E	F	G	H	I	Total Height	Max. Clamp Force	Gross Weight kg	Meas CFT	CODE NO.
VW-3	81	30	80	127	14	400	185	240	130	475	800kgs	(C)16.7	0.7	1002-080
VW-4	110	37	116	145	16	535	238	317	180	595	1000kgs	(C)32.7	1.2	1002-081
VW-5	135	37	145	167	18	620	270	357	210	690	1600kgs	(W)49.4	1.6	1002-082

## 2-Way Machine Vise



- Heavy cast iron structure
- Scales in both axis
- 360° swivel around Z-axis
- 90° vertical and horizontal swivel

### Specifications

Unit:mm

ORDER NO.	Jaw		C Max. open	Alignment slot	Height	L x W x H (OVERALL)	Max. Clamp Force	Weight (kgs)	Packing	CODE NO.
	Width	Height								
VWT-5	125	46	100	16	160mm	410x315x160	900kgs	31.7	432x330x190	1002-090
VWT-6A	160	51	120	16	195mm	430x320x195	1600kgs	47	510x365x240	1002-091