

## Build Out Type

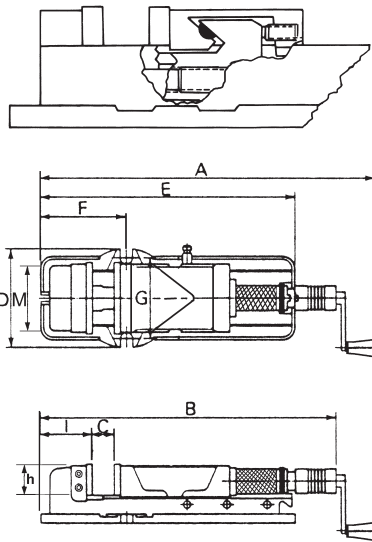

### Features

- Rigid material-vise body of ductile iron FCD 60JIS (equal to GGG 60) with 60 kgs/mm<sup>2</sup> or 80,000 psi tensile strength.
- Vise bed flame hardened to HRC 45 and up, takes up wear and maintain accuracy for long.
- For multiple use plural vises are available on tolerance of 0.01mm in the height of vise bed and in alignment of the clamping surface of the vise jaw at extra cost.
- Mechanical/hydraulic spindle without original clutch mechanism.
- Down thrust "Semi-sphere Segment" mechanism-eliminates jaw lifting and work fitting.
- All surface ground.



Unit:mm

ORDER NO.	A	B	C OPEN	D	E	F	G	I	M	h	CLAMPING FORCE	N.W. kgs	CODE NO.
VHO-5	695 920	570 795	0-220	190	505	180	160	105	130	55	3500kg	36.5	1002-220
VHO-6	750 1060	625 935	0-300	240	625	208	196	125	160	58	4000kg	59.1	1002-221
VHO-8	830 1140	725 1035	0-310	280	700	265	240	165	200	63	6000kg	94.3	1002-228

### Swivel Base Optional

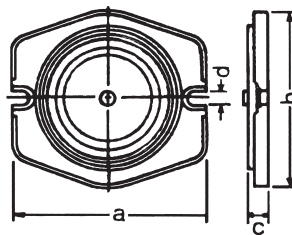

ORDER NO.	A	B	C	D	N.W. kgs	CODE NO.
HSO-5	285	263	35	16	12.5	1002-222
HSO-6	330	320	40	18	16.5	1002-223
HSO-8	415	413	50	21	35	1002-229

# Double Clamp Vise

NEW DESIGN & UNIQUE CONSTRUCTION.  
EXCLUSIVELY DESIGNED WITH COMBINATION OF  
MACHINABLE FIXTURE JAWS AND HARD JAWS



### HIGH & EXCELLENT RIGIDITY.

The vise is made of FCD. 80000 PSI (55 kg/cm<sup>2</sup>) Ductile iron, and the slide ways are hardened to HRC45. The rigid construction prevents the base from distortion. Precision made to high accuracy standard.

- The movable jaws provide alignment to workpiece without jaw lifting.
- The height of jaw plate is 30% higher than the other vise with the same size.
- There are 6 kinds of clamping ways to meet workpieces of different shapes and sizes.

### DOUBLE CLAMP SEAT:

One handle can simultaneously operate two movable jaws and clamps 2 pieces of workpiece of same size or different size or one large workpiece. This model can increase efficiency and productivity of CNC machine.

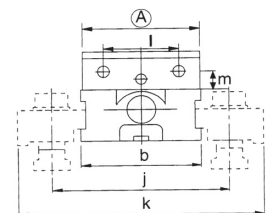
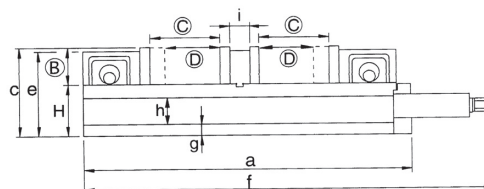

Unit:mm

ORDER NO.	A	B	C OPEN	D	a	b	c	H	e	f	g	h	i	j	k	l	m	Guide Block	Max. Clamp Force	Weight (kgs)	CODE NO.
VMC-6D	152	58	34-102	0-68	495	154	140	90	135	610	18	46	30	165	220	98.4	31.8	18		62.1	4005-021