

## Features

- Special design for quick clamping. (From the acme thread shaft stationly)
- Quick setting by sliding movement. Big clamping capability.
- Operating very quick and easy, can increase so much working efficiency than you can image.
- Good for short term and massive production or proto type work.
- Suit for milling machine, grinder machine, precision drilling machine using.
- Accurate grounded and assembled.
- Precision cut acme thread, it can get 900kgs high clamping force.
- Horizontal & vertical

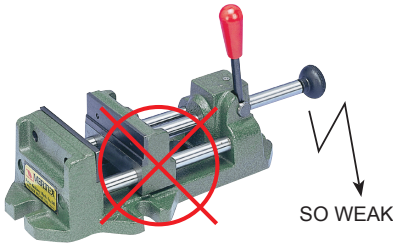
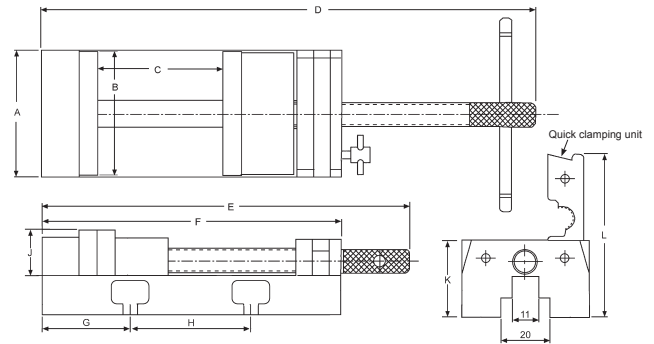

ORDER NO.	A	B	C OPEN	D	E	F	G	H	J	K	L	Max. Clamp Force	G.W.	CODE NO.
VQS-3	82	81	85	374	288	230	75	80	34	66	120	700kgs	7	1002-262
VQS-4	106	105	104	422	317	256	78	100	36	66	135	800kgs	9.5	1002-263
VQS-5	132	131	125	490	366	297	98	100	36	68	166	800kgs	14.5	1002-264

# Machine Vice For Shaping & Milling Use

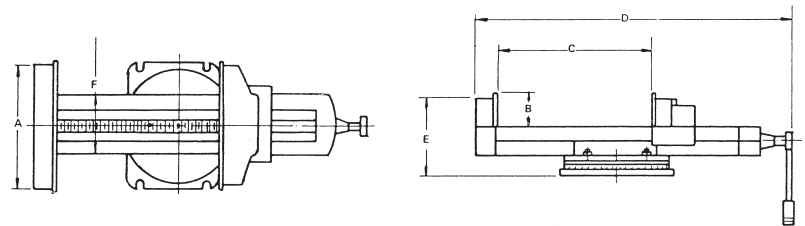

The vise is made of the high tension cast iron, rigidity, large range of clamping spans and more bigger clamping force at draw down jaws, especially suitable for the heavy duty cutting and the heavy duty planner milling machine to clamp large workpiece.

ORDER NO.	A	B	C OPEN	D	E	F	N.W./G.W. (KGS)	CODE NO.
VSM-12	300	70	300	650	210	220	80/83.9	1002-270
VSM-16	410	90	410	790	240	250	135/141.7	1002-271
VSM-20	500	90	500	910	250	305	175/200	1002-272